

# Operation manual

Model: AA17054

## Step 1.

Open the Fiber optic terminal box. Check and prepare installation tools and accessories. To establish easy and safe installation put the box where it will be installed and measure the required length of the cable. Prepare the safe installation of the box.



## Step 2.

Strip the cable the required length, minimum 0.5 meter or more, to establish easy and safe installation with enough buffer size. Fix the cable in the snapable tab with a cable tie (1) and put it in the box at its place. Coil the remaining cable in the box (2).

Pass the stripped cable into the upper side of the splice tray.

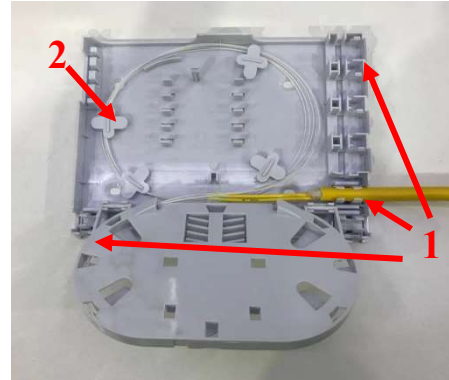

## Step 3

Connect the pigtails (1) on adapter (2) and pass the cable into the upper side of the splice tray (3).

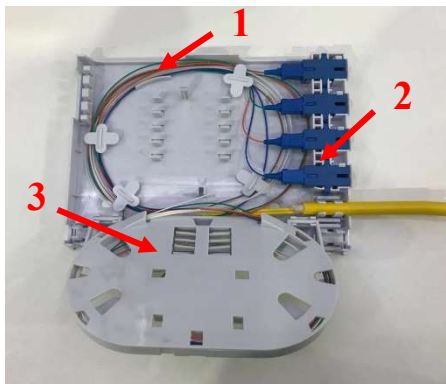

## Step 4

Splice the stripped cable (1) with the pigtails (3) Place the splice sleeves in the splice tray (2).

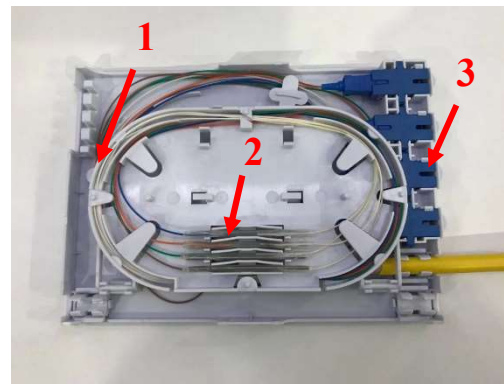

## Step 5

Put on the splice tray cover (1) after splicing finished.

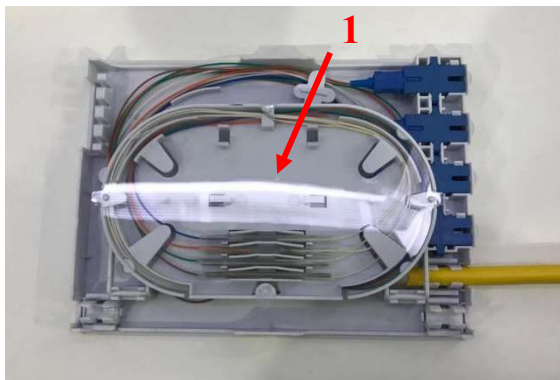

## Step 6

Close the cover after finishing the basic light test or the measuring of all fibers.

